

HILINE

4 Page Newspaper Offset Press



MANUGRAPH
Technology in Print

Hiline - An efficient press for meeting various Printing requirements

Hiline is a single width, single circumference press from Manugraph. Hiline is compact, operator friendly and easy to maintain. Hiline puts the major focus on multicolour printing with H unit and Tower unit models and the right level of automation giving maximum output of 45,000 copies an hour with an excellent price performance ratio. Hiline facilitates a wide gamut of printing applications such as Newspaper, Supplements, Books, Magazines etc.

HILINE Features at a glance

- Max. Printing speed 45,000 copies per hour.
- Flying splicer in Inline, 90°, Basement, Stacked or Integrated version as per customer's requirement.
- PIV driven tension roller with driven nip (for 6 Towers and above configuration).
- Plain type rigid wall at O.S. & G.S.
- Pneumatics for impression, inking and dampening form roller, ink take up roller on-off.
- 8 roller inking system with 2 oscillating rollers & 2 form rollers of different diameters.
- 4 Roller contact less Brush Dampening system.
- Tower electricals are accommodated in operating side enclosure.
- Remote register and cut off control (open loop).
- Auto tracking of Ink duct and Water pan roller.
- Auto bearer lubrication.
- Web severers and Inertia roller on Tower as a safety measure in case of web breaks.
- Motorized Bustle Wheels to minimise fanout.
- Jaw Folder - F2:2:2 & F860.
- PLC base Electrical System.
- 2 Touch panels per Tower for Print function.
- Shafted AC drive system.

Options Available

- Manucolor remote ink zone control and CIP3 interface.
- Close loop Registration and Cut off control.
- Spray Dampening system.
- Shaftless AC Servo drive system (Footprint base or H unit base).

Criteria for selection of your Hiline Print Unit Modules

Printing units are available in H and Tower configuration. A Tower is made up of stacked 2 H Units for printing 4x4 color. A Wide variety of printing possibilities i.e. 4x1, 4x2, 4x4 are available. Also output of two webs from Tower unit to get 2x2 printing on each web is possible. Short Web path ensures state of the art print quality. Optimized design of Tower in terms of width & height results in space saving. Tower with integrated Flying Splicer is a solution for presses having less floor space and more pagination. Splicers can be configured in the pressline either Inline, 90°, Basement or Integrated to suit the space available. User friendly, Flexibility in production, add-on to any existing pressline, and 24x7 service support are the key points for selecting Hiline.

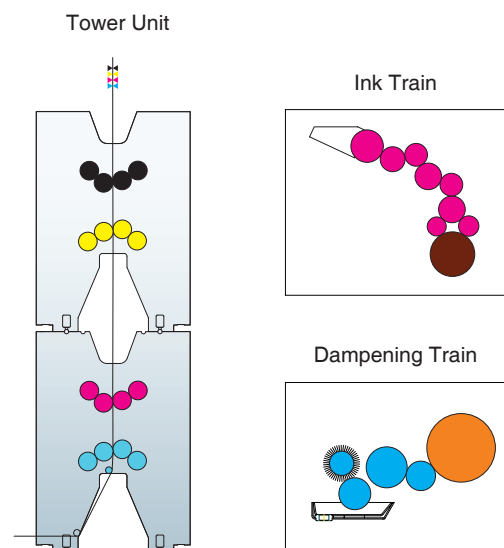

Tower with Integrated Splicer

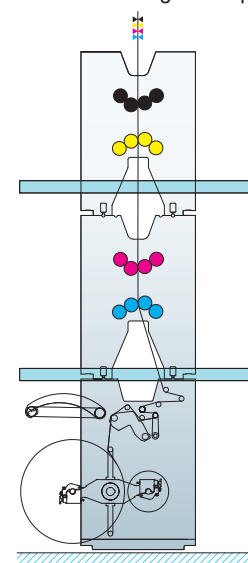

Cylinders for the best performance

- Solid steel, dynamically balanced hard chrome plated plate and blanket cylinders running on alloy steel bearers and supported on precision taper roller bearings.
- Toolless plate lock up.
- Register wedges for true register.
- Narrow gap Reel rod type Blanket Clamping system.

Plate and Blanket Cylinder

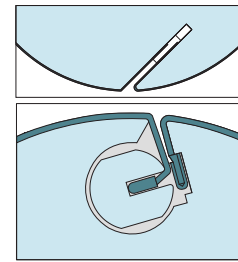

Jaw Folder - F2:2:2 / F860

Hiline offers a choice of 2 rigid Folders to suit different pagination requirements. Varieties of folding modules are available as an attachment like Quarter Fold, Parallel Fold, Balloon Former, etc.

Features

- Jaw folder F2:2:2 upto 6 webs.
- Jaw folder F860 upto 12 webs.
- PIV driven RTF roller.
- Air cushioned former.
- Lap adjustment facility.
- Slitter mechanism for tabloid production.
- Folding cylinder with diameter increment facility.
- Shear pin for overload protection in the folder driveline.
- Electronic multi sheet detection facility.
- Adjustable batch counter.
- Web severer.
- Motorized rotary cut off compensator on Folder.

Options Available

- Quarter Fold Chopper type.
- Double Parallel Fold.
- Cross perforation option for Quarter Fold.
- Balloon former and Upper balloon former.
- Gluing and Stitching attachment.

F2:2:2



F860



Flying Splicer - AP4550

- Standalone Splicer suitable for handling 1270 mm (50") reel diameter.
- Splicing diameter range 700 - 1270 mm.
- Motorized belt acceleration.
- Swing type knife and sponge roller assembly.
- PLC based electro-pneumatic braking system.
- Dual braking system for consistent and precise braking.
- Reel loading and unloading from same side.
- Hydraulic web trolley moved on fixed cross rails for easy reel loading.
- Pneumatic reel shaft.
- Motorized lateral reel shifting (optional).
- Shaftless Infeed system with loadcell arrangement (optional).

AP4550



Central Console

Central Console & Press Drive

- Centralised Control for Press Controls and auto sequential mode printing functions.
- Touch panel for press controls and display.
- Manucolor remote ink zone control (optional).
- Shafted AC drive system as per configuration.
- Option of DC shafted drive.
- Option of AC Servo shaftless drive footprint or H base.
- Fault diagnostics and periodic maintenance guidelines & remote diagnostics.



Specifications

Max. Printing Speed 2nd Fold	45,000 c.p.h.	
Max. Reel Diameter	1270 mm (50")	
Web Width	700 mm (27.5")	
Printing Unit Modules	H and 4 Hi Tower with vertical web leads	
Cut-off Length	533 (21"), 546 (21½"), 578 (22¾"),	
Plate Mounting	Toolless plate lock	
Flying Splicer	Standalone, Integrated, 90°, Basement or Stacked placement	
Folder:	F2:2:2	F860
Max. No. of Webs	6 webs	12 webs (8 webs on main former + 4 webs on BF)
Quarter Fold	4 webs / 35,000 c.p.h.	4 webs / 35,000 c.p.h.
Double Parallel Fold	2 webs / 35,000 c.p.h.	4 webs / 40,000 c.p.h.
Balloon Former	2 webs	4 webs
Upper Balloon	2 webs	2 webs
Data Management	PLC based	
Accessories	<ul style="list-style-type: none"> • Plate punching device • Set of tools • Web trolley for reel loading • Plate bending device • Set of spare parts • Centralised chilled water tank 	
Optionals	<ul style="list-style-type: none"> • Manucolor Remote ink zone control system • CIP3 interface to Manucolor for ink presetting • Close loop registration and cut off control • Spray dampening system • Belt type Webbing up system for Tower • Turner bar and Bay window • Footprint or Unit base shaftless drive • Heatset package • OE system integration - UV curing, Stitcher, Gluing, VDP i.e. Bar coding and Digital numbering 	

CONFIGURATION

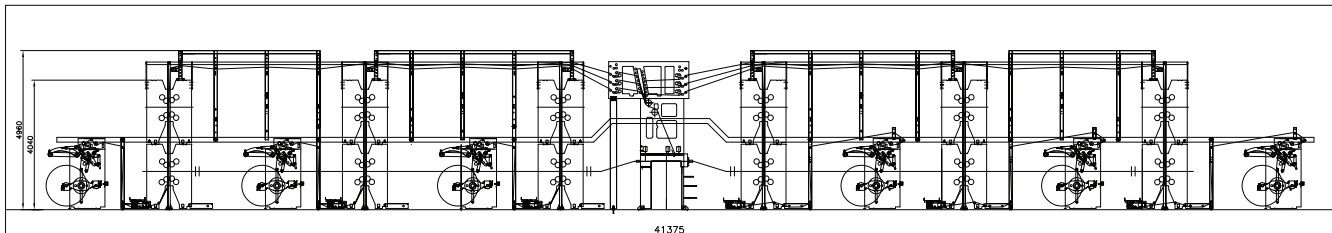

Manugraph India Ltd.,
 SIDHWA HOUSE, N.A.Sawant Marg,Colaba, Mumbai.400 005, INDIA Phone : +91-22-2287 4815/4788/1191/0620,
 Fax : 91-22-2287 0702, E-mail : sales@manugraph.com, Website: www.manugraph.com

Hiline is subject to continuous upgradation resulting from ongoing research and development and practical experiences gained. Therefore, in the interest of the customers we reserve the right to modify the specifications, features and technical data without notice. Only the specifications while confirming the order shall be binding. Hiline is a registered trademark of Manugraph India Ltd.